

To make the camera run on Windows 10

If you have already plugged it in and had problems you need to go disconnect the camera and then go to: Start > Settings > devices>Device Manager.

In the list that appears in the device manager, select imaging devices and then right click on the USB camera and click uninstall (if it asks you if you wish to remove the driver as well, click yes).

(Note: If you cannot see the USB camera in this list, go to the top of the windows and select the view menu and then select show hidden devices. Then repeat the step above).

You now need to change how windows 10 searches for drivers, this is very easy:

Go to the search box at the bottom left of your home screen and type in the word "system", the first or second option will read "System Control Panel". Select that one from the list.

In the list on the left of the window select "Advanced System Settings". Select the hardware tab at the top of the new window that opens and then press the "Device Installation Settings" button. Once you have done that set the next page up as you can see in the image below:

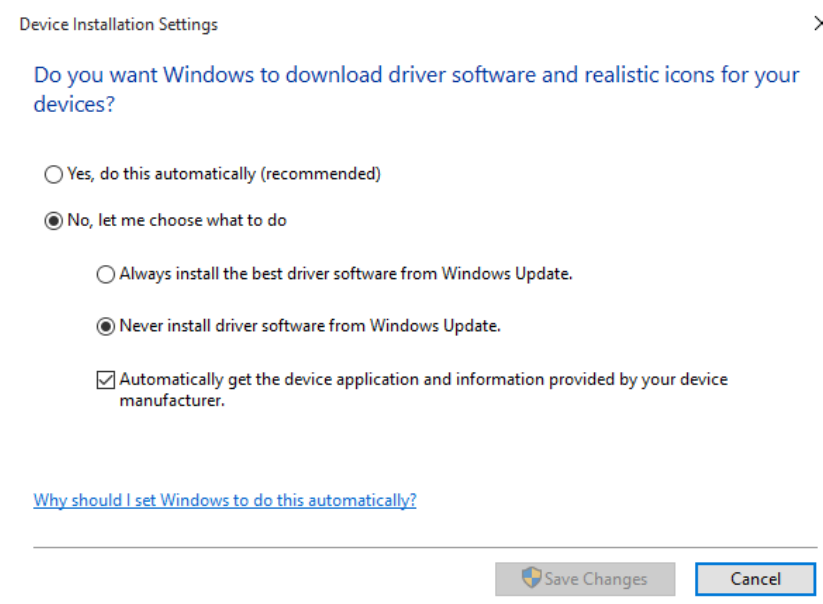

And then Press Save changes. You can now exit this window.

Now plug you camera/scanner back in and it will pick up the correct driver (normally signified by the computer emitting a musical 4 note tone). Wait a few seconds and then open the nhs camera software.

If the software does not open this means the camera hasn't been picked up by windows, disconnect the camera wait 10 seconds and reconnect it (using a different USB port can sometimes help).